

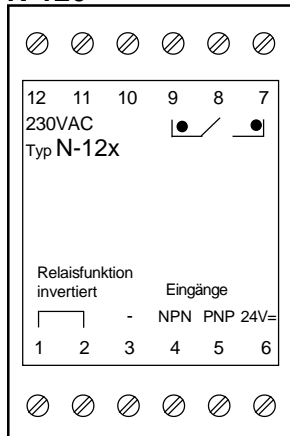
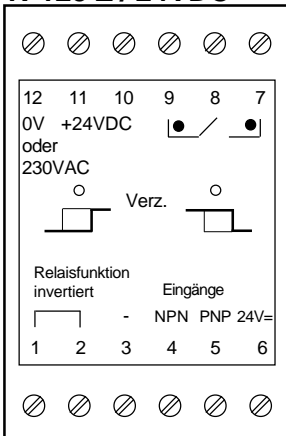
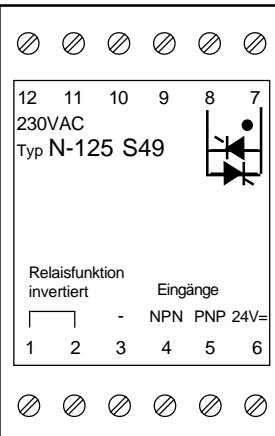

# Original Operating Manual: Power Supplies series N-12x

**N-124-S, N-125,  
N-126**

**N-24-S, N-125 Z  
N-125 Z / 24VDC**

**N-125 S49**

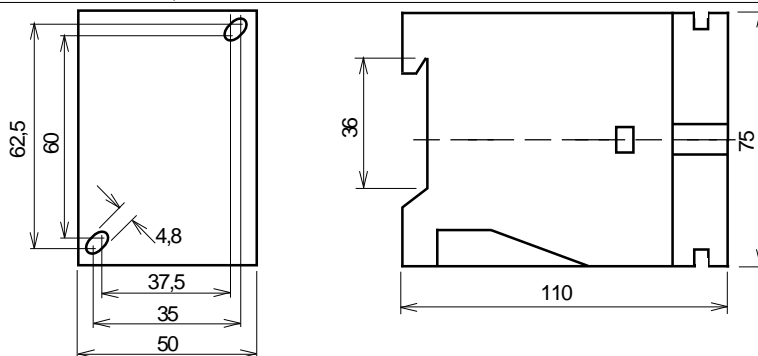
**Connection layout:**

- P 1/2: Selection of the reversal function. (Function inverted if Pins 1 + 2 closed)
- P 3/6: Output voltage 24VDC, (stabilized)
- P 4: PNP compatible input
- P 5: NPN compatible input
- P 7-9: Relay output contact  
LED red - Relay activated  
LED green - deactivated
- P 7/8: S49, Solide State Relay  
LED red - activated
- P 10: Not connected NC
- P 11/12: AC-Devices: Nominal AC input voltage on the typelable
- P 11: DC-Devices: +24VDC
- P 12: DC-Devices: 0V

Model	N-125 N-124-S	N-125 Z N-24-S	N-126	N-125 S49	N-125 Z /24VDC
Technical data					
Supply voltage	230 VAC +10%/-15% also for 115 VAC or 24 VAC, on request				24 to 30VDC
Connectable sensors	1 x Proximity switch or 1 x light barrier				
Switching output	1 x Relay contact: C, NC, NO			1 x Semiconductor	1 x Relay
Maximum output load AC	250VAC 6A/500VA			24 to 250VAC 3A/750VA	250VAC 6A/500VA
Maximum output load DC	30VDC/6A/150W			--	30VDC/6A
Stabilized output voltage	24VDC+-10%				
Maximum output current	75mA	75mA	140mA	90mA	100mA
Indication LED	red/green			red	red/green
Switching frequency	max. 5Hz	max. 5Hz	max. 5Hz	50Hz	max. 5Hz
Delay function (adjustable by potentiometer)	--	0.1 to 10 sec rise and fall time delay	--	--	0.1 to 10 sec rise and fall time delay
Mounting	On DIN rail at DIN EN 50022 or with 2 screws				
Options	Other delay times on request				

**Dimensions**

**Betriebsanleitung / EG-Konformitätserklärung:**
**Mounting prescriptions**

The power supply must only be driven with the rated input voltage, marked on the serial number label.

**Function**

The power supplies models N-12... are usable for the supplying and the signal conditioning of photoelectric sensors. If the PNP or the NPN compatible input will be activated, the relay is activated and the LED shows red. If no input is activated the relay is released and the LED shows green. For the Z models, a rise and fall time can be adjusted by 2 potentiometers.

**Maintenance**

No special maintenance is required. If the power supply is contaminated, clean with alcohol. Do not use aggressive solvents. Equipment must only be repaired or serviced by the manufacturer.

**Durability of the relay contacts**

At a nominal load of 250VAC/6A the working life is appr.  $2.5 \times 10^6$  switching cycles. Stronger loads can decrease the working life massive.

**Safety Informations**

When installing and operating with the power supplies, it is necessary to take into consideration

the relevant international and other national regulations.

Standards met:

- EN 61000-6-1/-2, EN 61000-6-3/4, EN 60204
- Machine directive: 2006/42/EC
- EMC directive: 2004/108/EC
- RoHS directive: 2011/65/EU

**General Notes**

We reserve the right to modify our equipment. Our equipment is designed such way, that it has the least possible adverse effect on the environment. It neither emit or contain any damaging or siliconized substances and use a minimum of energy and resources. No longer usable or irreparable units must be disposed of in accordance with local waste disposal regulations.

**CE Declaration of Conformity**

The conformity of the devices with the EC standards and directives and the observation of the Quality Management System ISO 9001:2008, declares:

Hans Bracher, Matrix Elektronik AG

**Tippkemper - Matrix GmbH**  
Meegener Str. 43 D-51491 Overath  
Tel.: +49 2206 9566-0 Fax -19  
info@tippkemper-matrix.com

**Matrix Elektronik AG (Manufacturer)**  
Kirchweg 24 CH-5420 Ehrendingen  
Tel.: +41 56 20400-20 Fax -29  
info@matrix-elektronik.com